

D-Neo Toilet Bowl # 200601..00 / 200601..85 / 200601..00 / 200601..85

| < 14 3/4 " > |

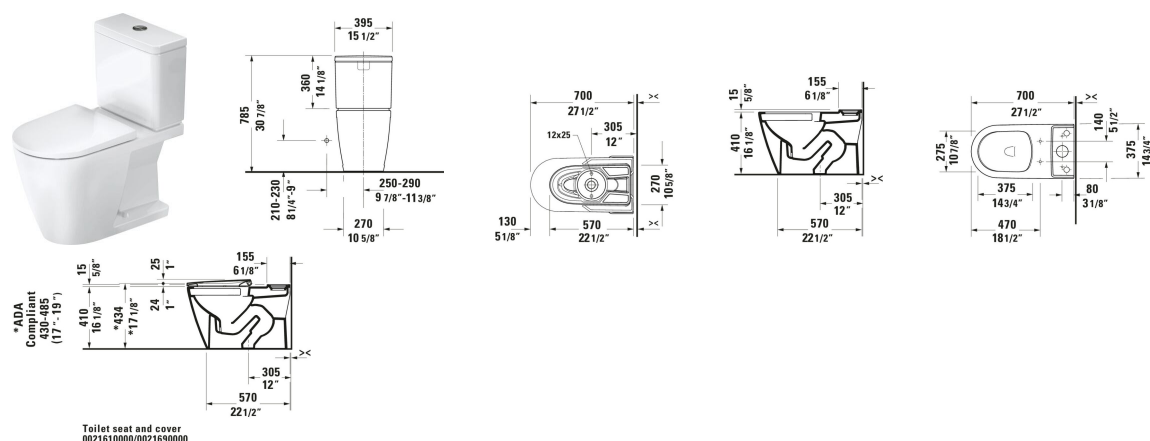

Toilet Bowl	Dimension	Weight	Order number
27 1/2 ", elongated, Siphonic, Rimless, Outlet vertical, ADA: Yes			
Colors			
00 White 20 HygieneGlaze (an antibacterial ceramic glaze that provides almost indefinite effectiveness)			
Variant			
White High Gloss, Flush water quantity: 1.32/0.92 gal, WaterSense: Yes, cUPC listed: Yes	14 3/4 "x27 1/2 "	99.208 lb	200601..00
White High Gloss, Flush water quantity: 1.28 gal, WaterSense: Yes, cUPC listed: Yes	14 3/4 "x27 1/2 "	99.208 lb	200601..85
White High Gloss, HygieneGlaze, Flush water quantity: 1.32/0.92 gal	14 3/4 "x27 1/2 "	99.208 lb	200601..00
White High Gloss, HygieneGlaze, Flush water quantity: 1.28 gal	14 3/4 "x27 1/2 "	99.208 lb	200601..85
Accessory			
Installation Set	2 3/8 x 5 1/8 "	1.874 lb	001417
Suitable products			
Toilet Seat , 19 1/4 x 14 3/4 "	19 1/4 x 14 3/4 "		002629
Toilet Tank Dual Flush, Water connection position: Bottom left 15/16 inches, Surface of push button: Chrome, Concealed connection, 15 1/2 x 7 1/8 "	15 1/2 x 7 1/8 "		094420
Toilet Tank Single Flush, Water connection position: Bottom left 15/16 inches, Surface of push button: Chrome, Concealed connection, 15 1/2 x 7 1/8 "	15 1/2 x 7 1/8 "		094421

All drawings contain the necessary measurements which are subject to standard tolerances. They are stated in inch & mm and are non-binding. Exact measurements, in particular for customized installation scenarios, can only be taken from the finished ceramic piece.