

ALLURE 1500

Freestanding Bathtub

MODEL NUMBER: ALLURE 1500

Contemporary, ergonomic and comfortable, the Freestanding Bathtub with Built-in Drain System features harmonious clean lines and bathing well for pure pleasure.

DESCRIPTION

- One piece freestanding bathtub
- 100% Lucite acrylic material made bathtub, smooth and glossy surface
- High thermal water heat retention
- Built-in overflow and pop-up drain system, brass material prevent pipe leaking
- Six of level adjustment feet, solid and stable



SPECS

Overall Size:	59"W x 24"H x 30"D
Product Weight	43.09kg
Drain Placement	Centre
Capacity	60 gallons
Rough-in Included	Not Included

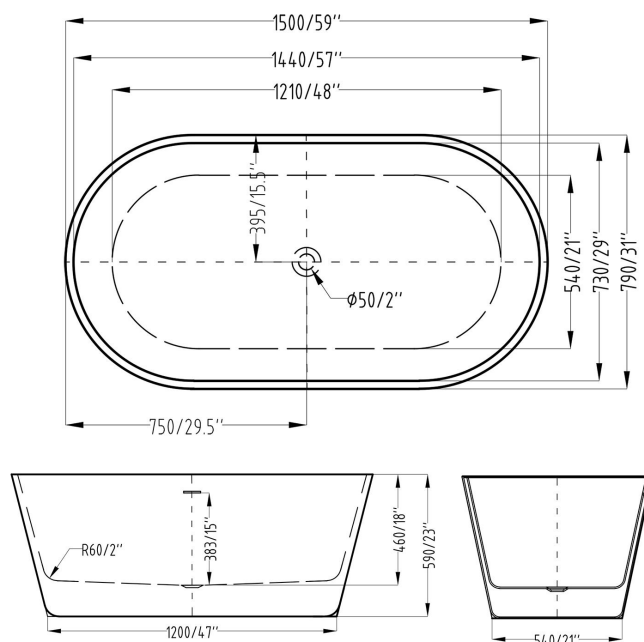

CERTIFICATES & WARRANTY

- cUPC compliant
- Limited Five Years Warranty