Wall-hung Toilet set with Duravit In-wall Carrier



INCLUDED

- ALPS Wall-hung Toilet Bowl KW-9009W
Flush rate: 1.6/1.1 gpf
Quick-release & Soft Close seat
- Duravit Durasystem In-Wall Carrier 1.6/0.8 Gpf
- Duravit Plastic Actuator Plate



cUPC Certified



Water Sense Compliant



5 Years Guarantee



Lifetime Warranty

Features

Easy cleaning

clean the entire floor with a damp mop, no bending or kneeling

Improved accessibility

requires less space than a standard toilet, enhancing safety and comfort; adjustable bowl height meets personal preference or ADA guidelines

Water savings

built-in dual-flush, 1.6 / 0.8 GPF saves thousands of gallons every year

Superior function

engineered Geberit fill and flush valves eliminate problematic chains and flappers that corrode and fail

Round Bowl

Glazed ceramic

Adjustable bowl height

Quick-release, soft-close seat

Wall-Mounted Toilet

KW-9009W



Features:

- Space saving, wall-hung design
- Glazed ceramic
- Adjustable bowl height
- Quick-release, soft-close seat
- Flushing Rate: 1.6/1.1 gpf

Installation:

- Wall hung

Specifications:

- N.W: 68.28 lb.
- Size: 19.36x14.17x14.17"

Included Parts:

- Wall-Hung Bowl
- Stainless Steel Toilet Seat Hardware
- Quick-Release Seat
- Mounting Hardware

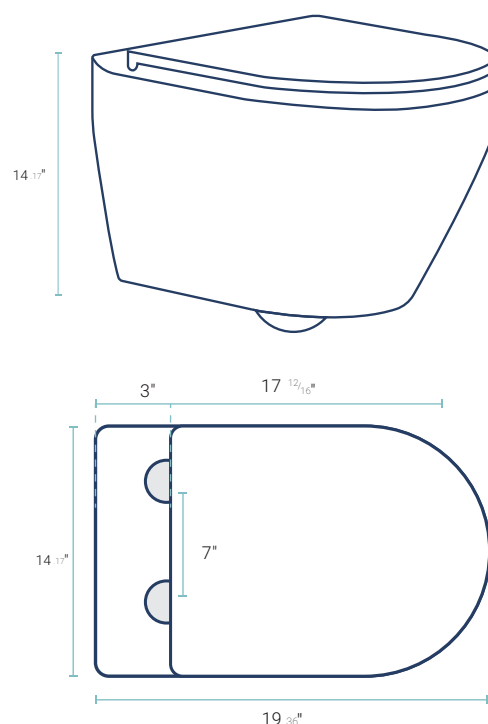
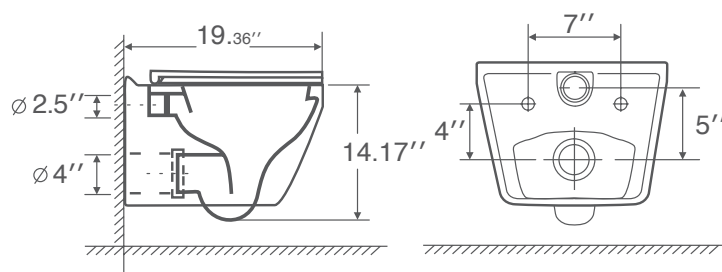

It's compatible with most in-wall carrier system brands.

DuraSystem® In-Wall Tank & Carrier Standard # WD1022000090 / WD1022000091

| < 23 1/4 " > |

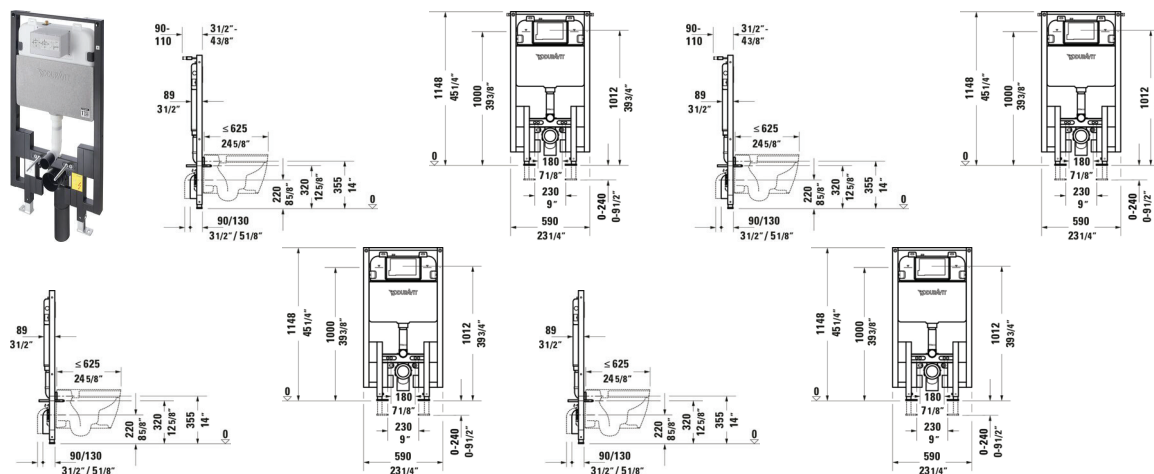

In-Wall Tank & Carrier Standard	Dimension	Weight	Order number
Includes HDPE toilet wall-mounted outlet bend DN 90/90, Powder-coated, Installation Type: In lightweight stand construction, Installation Type: Drywall, Max. projection toilet: 24 5/8 ", Adjustable height: 9 1/2 ", Trip lever type: Mechanical, Trip lever placement: Front, Adjustable flush volumes, Flush type: Dual Flush, Insulated tank, Self-supporting, Suitable for panelling with plasterboards			
Colors			
00 White			
Variant			
1.6 gal, Small flushing volume: 0.8 gal, Large flushing volume: 1.6 gal	23 1/4 "x45 1/4 "	39.683 lb	WD1022000090
1.28 gal, Small flushing volume: 0.8 gal, Large flushing volume: 1.28 gal	23 1/4 "x45 1/4 "	39.683 lb	WD1022000091
Suitable products for 1.6 gal, Small flushing volume: 0.8 gal, Large flushing volume: 1.6 gal			
Actuator Plate A1 Plastic, Dual Flush, Trip lever type: Mechanical, Flush operation technology: Manual, Installation Type: surface mounted, Includes mounting frame, including mounting kit, Includes push rod	8 1/2 x 3/8 "	0.69 lb	WD5008
Installation accessories			
Installation Set	5 3/8 x 4 1/8 "	0.948 lb	005072
Suitable products			
Actuator Plate Glass, White, Dual Flush, Trip lever type: Mechanical, Flush operation technology: Manual, Installation Type: surface mounted, Includes mounting frame, including mounting kit, Includes push rod	8 1/2 x 3/8 "	1.049 lb	WD5011

DuraSystem® Actuator Plate A1 # WD5008..1090 / WD5008..1090 / WD5008..1090

|< 8 1/2 " >|

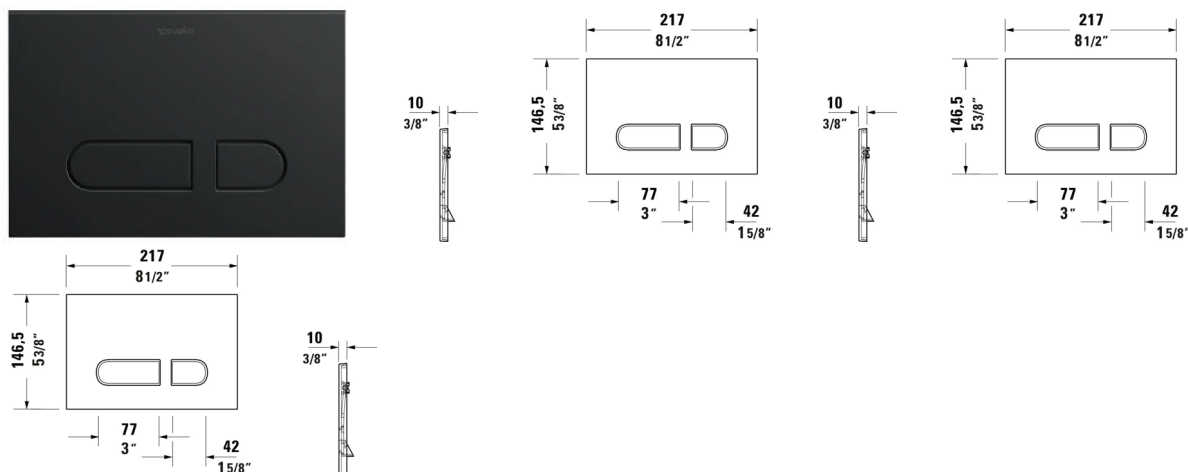

Actuator Plate A1	Dimension	Weight	Order number
Plastic, Dual Flush, Trip lever type: Mechanical, Flush operation technology: Manual, Installation Type: surface mounted, Includes mounting frame, including mounting kit, Includes push rod			
Colors			
00 White 10 Chrome 46 Black Matte			
Variant			
White	8 1/2 "x5 3/4 "	0.690 lb	WD5008..1090
Chrome High Gloss	8 1/2 "x5 3/4 "	0.690 lb	WD5008..1090
Black Matte	8 1/2 "x5 3/4 "	0.690 lb	WD5008..1090
Suitable products for White			
In-Wall Tank & Carrier Standard Includes HDPE toilet wall-mounted outlet bend DN 90/90, Powder-coated, Installation Type: In lightweight stand construction, Installation Type: Drywall, Max. projection toilet: 24 5/8 ", Adjustable height: 9 1/2 23 1/4 x 3 1/2 "		39.683 lb	WD1022

All drawings contain the necessary measurements which are subject to standard tolerances. They are stated in inch & mm and are non-binding. Exact measurements, in particular for customized installation scenarios, can only be taken from the finished ceramic piece.